



SWITCH TYPE	Tact Switches	MODEL NO.	TS015C-01MVB-160
-------------	---------------	-----------	------------------

1. Functional spec.

1.1 Rated Voltage	DC 12V	1.6 Free Position	3.5 ± 0.2mm
1.2 Rated Current	50mA	1.7 Operating Position	
1.3 Contact Resistance	≤ 100mΩ (Initial value)	1.8 Position Travel	0.2 ± 0.1mm
1.4 Operating Force	160 ± 50gf	1.9 Bounce Time	≤ 5ms
1.5 Return Force	> 15gf	1.10	

2. Reliable Rating

2.1 Mechanical Life	50,000 CYCLES	2.5 Soldering Technic	Hand/Reflow soldering
2.2 Electrical Life	50,000 CYCLES	2.6 Operating Temper	-20°C - +70°C
2.3 Insulation Resistance	≥ 100MΩ DC100V (Initial value)	2.7 Ambient Humidity Used	< 85%RH
2.4 Withstand Voltage	AC250V 1 minute (Initial value)	2.8	

3. Dimension Drawing

P.C.B LAYOUT

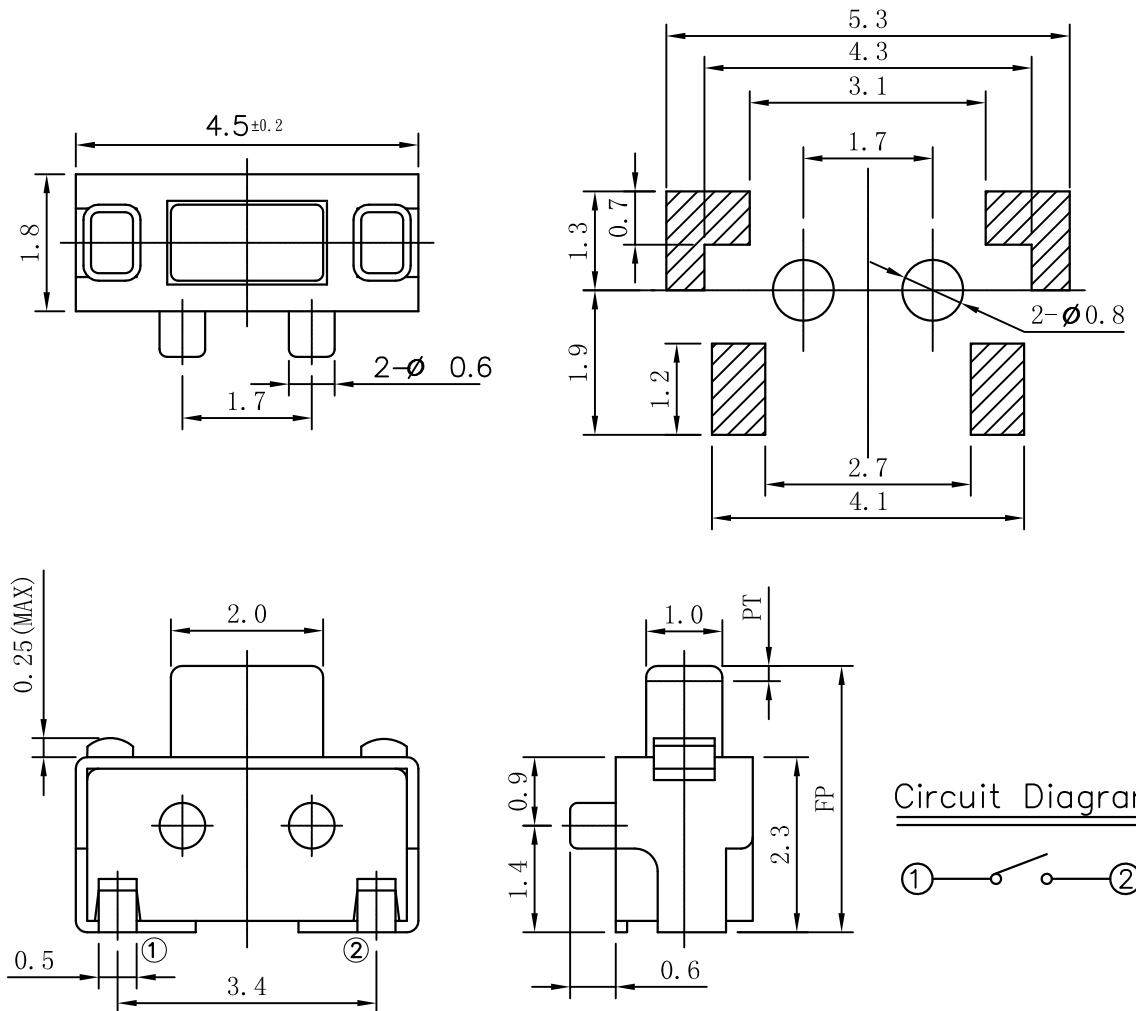

Circuit Diagram

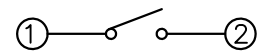

Revision	Description			Date	Revisor
Drawing No.	C/0			Tolerance	±0.2
Drawing Model.	SPECIFICATION OF STANDARD TYPE			Unit	mm
Prepared	Tess	Reviewed	Dragon, Dung	Approved	Kingsel, Wu
				Effective date	20080618